

Directions for IP66 Cable Connectors

AvertX IP66 Cable Connectors will protect the wire connection from weather in unprotected outdoor locations. It is not needed in an indoor or weather protected location.

1. On the Cat5e camera cable, unscrew the thread lock cap and slide it back a few inches

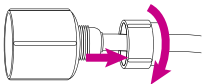

2. Separate and slide all parts of the connector back a few inches

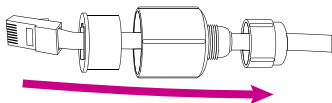

3. Plug the RJ45 Connector into the camera dongle

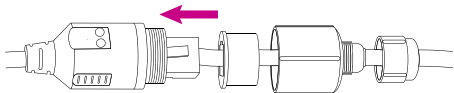

4. Slide the connector inner boot completely over the RJ45 connector. Be careful that the connector's locking tab is inside of the mating slot

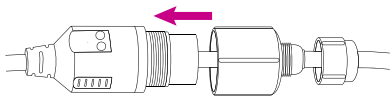

5. Slide the connector over the inner boot and twist to tighten. Only tighten the connector hand tight. Over tightening of the connection can damage the camera dongle

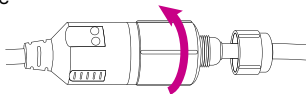

6. Slide the thread lock cap onto the connector and twist to tighten

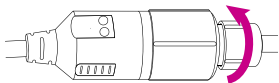

7. To remove connector, reverse the steps